

# Metrolink Eccles line rail maintenance works – summer 2016

## Weaste Metrolink stop **Phase 1**

A major track replacement programme will see the Eccles via MediaCityUK Metrolink line temporarily close from Sunday 26 June. Transport for Greater Manchester has worked with Metrolink's operator and maintainer, MRDL, to time the essential upgrades to coincide with final works at St Peter's Square stop, when fewer people will be travelling due to the summer holiday period.

Eccles line services are expected to resume between Deansgate-Castlefield and MediaCityUK in early August, with the full line reopening at the end of August.

On-highway works will take place at Weaste Metrolink stop, at the junction of Eccles New Road, Foster Street and Mode Wheel Road, from **Sunday 10 July for approximately 16 days**. While no lane or road closures are required for these works, temporary traffic lights will be in place to allow for safe working and management of traffic on the highway.

The work at Weaste Metrolink stop will be in three phases, with each phase taking approximately five days (**please note, all dates are subject to change**).

During **phase 1**, there will be no right turn onto Eccles New Road from Mode Wheel Road/no left turn onto Mode Wheel Road from Eccles New Road. Traffic signals will be staffed 7am to 9.30am and 3.30pm to 5.30pm Monday to Friday.

A signed diversion via Eccles New Road and Ladywell roundabout at the junction with Gilda Brook Road will be in place during this phase. Access will be maintained during the works.

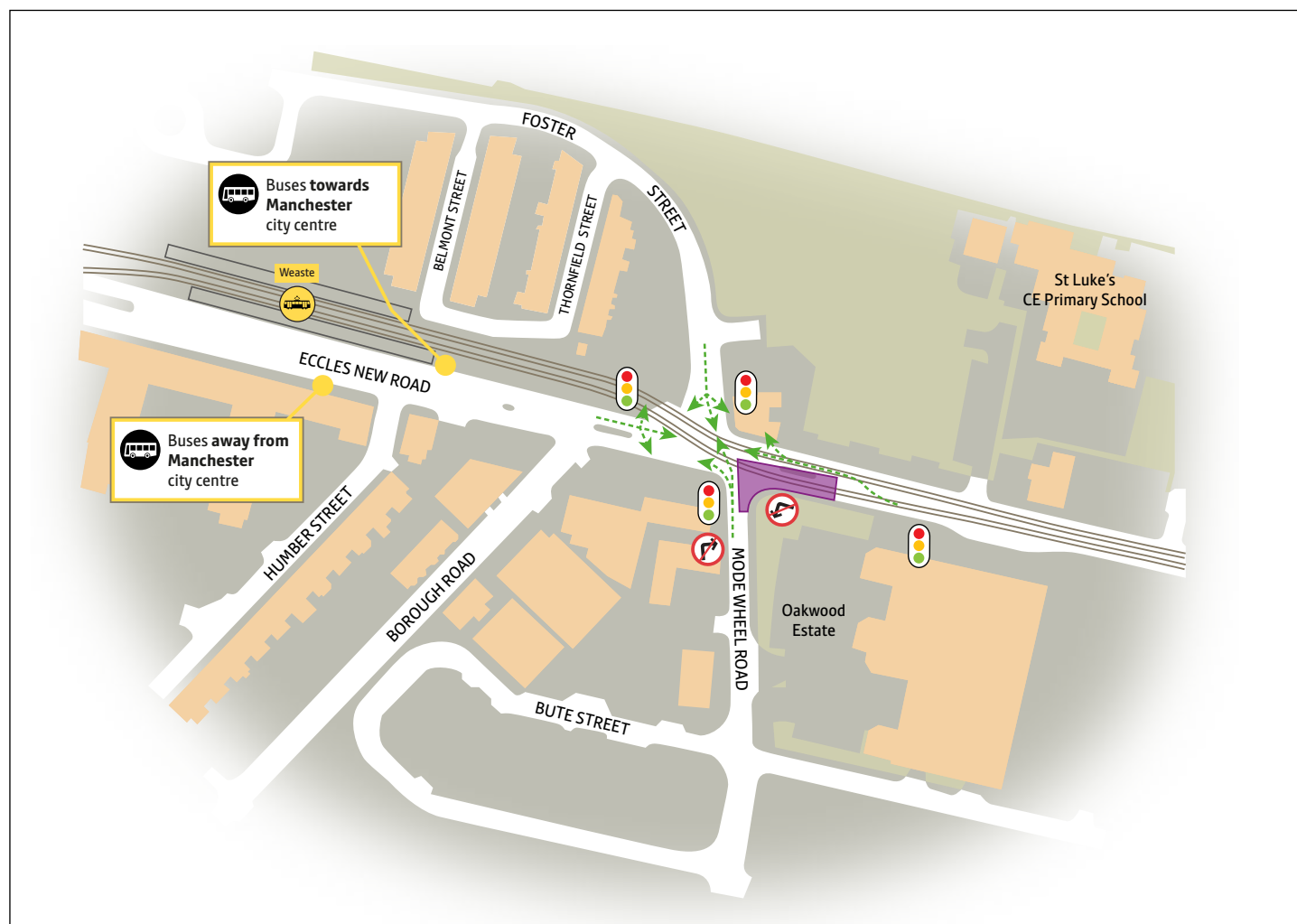

	Work site		Temporary traffic lights
	Replacement bus service temporary bus stop		Temporary prohibited turns
	Metrolink stop		Traffic flow



© Crown copyright and database rights 2012 Ordnance Survey 0100022610. Use of this data is subject to terms and conditions. You are granted a non-exclusive, royalty free, revocable licence solely to view the Licensed Data for non-commercial purposes for the period during which Transport for Greater Manchester makes it available; you are not permitted to copy, sub-license, distribute, sell or otherwise make available the Licensed Data to third parties in any form; and third party rights to enforce the terms of this licence shall be reserved to Ordnance Survey

# Metrolink Eccles line rail maintenance works – summer 2016

## Weaste Metrolink stop **Phase 2**

A major track replacement programme will see the Eccles via MediaCityUK Metrolink line temporarily close from Sunday 26 June. Transport for Greater Manchester has worked with Metrolink's operator and maintainer, MRDL, to time the essential upgrades to coincide with final works at St Peter's Square stop, when fewer people will be travelling due to the summer holiday period.

Eccles line services are expected to resume between Deansgate-Castlefield and MediaCityUK in early August, with the full line reopening at the end of August.

On-highway works will take place at Weaste Metrolink stop, at the junction of Eccles New Road, Foster Street and Mode Wheel Road, from **Sunday 10 July for approximately 16 days**. While no lane or road closures are required for these works, temporary traffic lights will be in place to allow for safe working and management of traffic on the highway.

The work at Weaste Metrolink stop will be in three phases, with each phase taking approximately five days **(please note, all dates are subject to change)**.

Access will be maintained during the works.

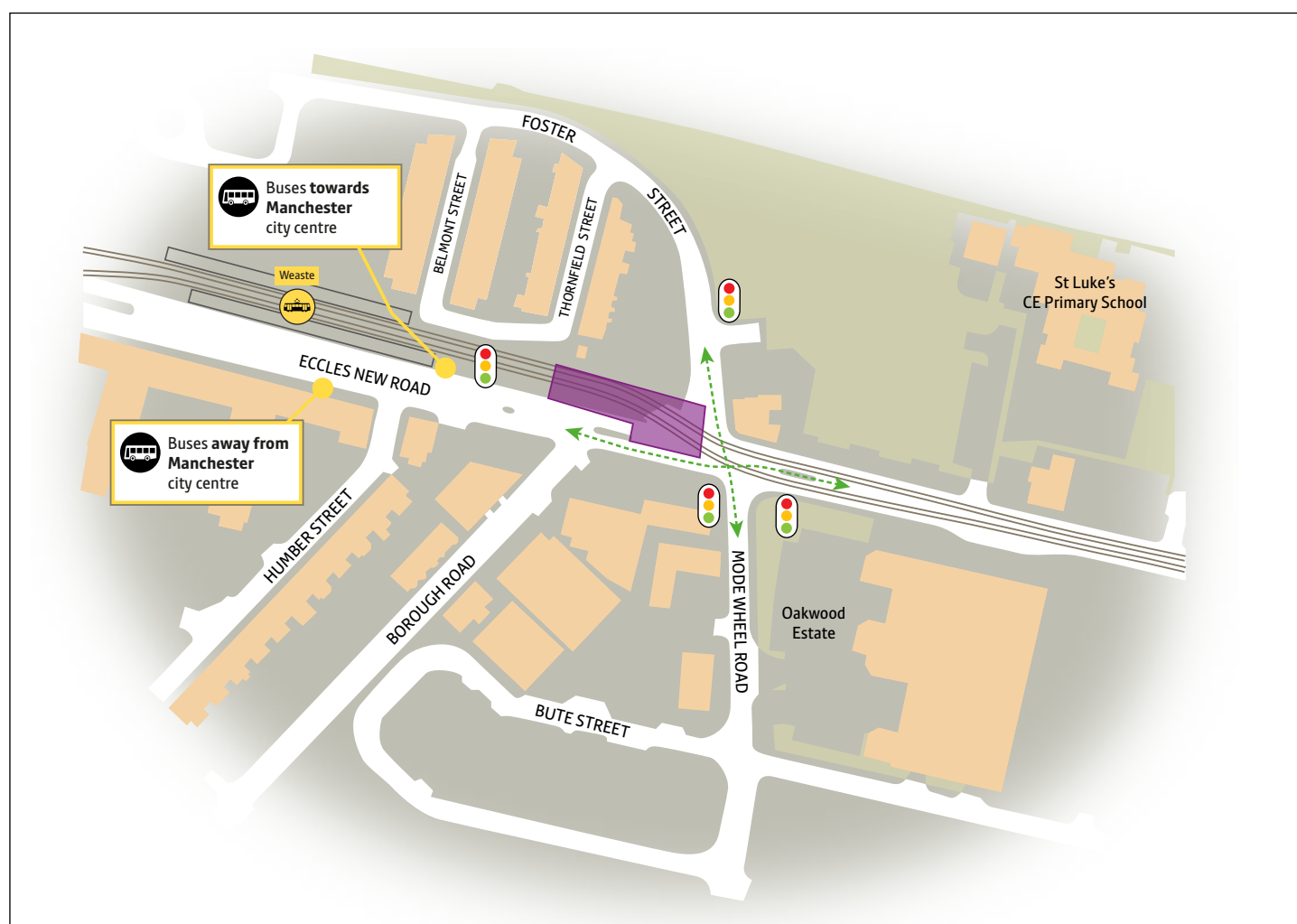

	Work site		Temporary traffic lights
	Replacement bus service temporary bus stop		Traffic flow
	Metrolink stop		



© Crown copyright and database rights 2012 Ordnance Survey 0100022610. Use of this data is subject to terms and conditions. You are granted a non-exclusive, royalty free, revocable licence solely to view the Licensed Data for non-commercial purposes for the period during which Transport for Greater Manchester makes it available; you are not permitted to copy, sub-license, distribute, sell or otherwise make available the Licensed Data to third parties in any form; and third party rights to enforce the terms of this licence shall be reserved to Ordnance Survey

# Metrolink Eccles line rail maintenance works – summer 2016

## Weaste Metrolink stop **Phase 3**

A major track replacement programme will see the Eccles via MediaCityUK Metrolink line temporarily close from Sunday 26 June. Transport for Greater Manchester has worked with Metrolink's operator and maintainer, MRDL, to time the essential upgrades to coincide with final works at St Peter's Square stop, when fewer people will be travelling due to the summer holiday period.

Eccles line services are expected to resume between Deansgate-Castlefield and MediaCityUK in early August, with the full line reopening at the end of August.

On-highway works will take place at Weaste Metrolink stop, at the junction of Eccles New Road, Foster Street and Mode Wheel Road, from **Sunday 10 July for approximately 16 days**. While no lane or road closures are required for these works, temporary traffic lights will be in place to allow for safe working and management of traffic on the highway.

The work at Weaste Metrolink stop will be in three phases, with each phase taking approximately five days (**please note, all dates are subject to change**).

During **phase 3**, there will be no left turn onto Eccles New Road from Foster Street/no right turn onto Foster Street from Eccles New Road. Traffic signals will be staffed 7am to 9.30am and 3.30pm to 5.30pm Monday to Friday.

A signed diversion via Eccles New Road and Ladywell roundabout at the junction with Gilda Brook Road will be in place during this phase. Access will be maintained during the works.

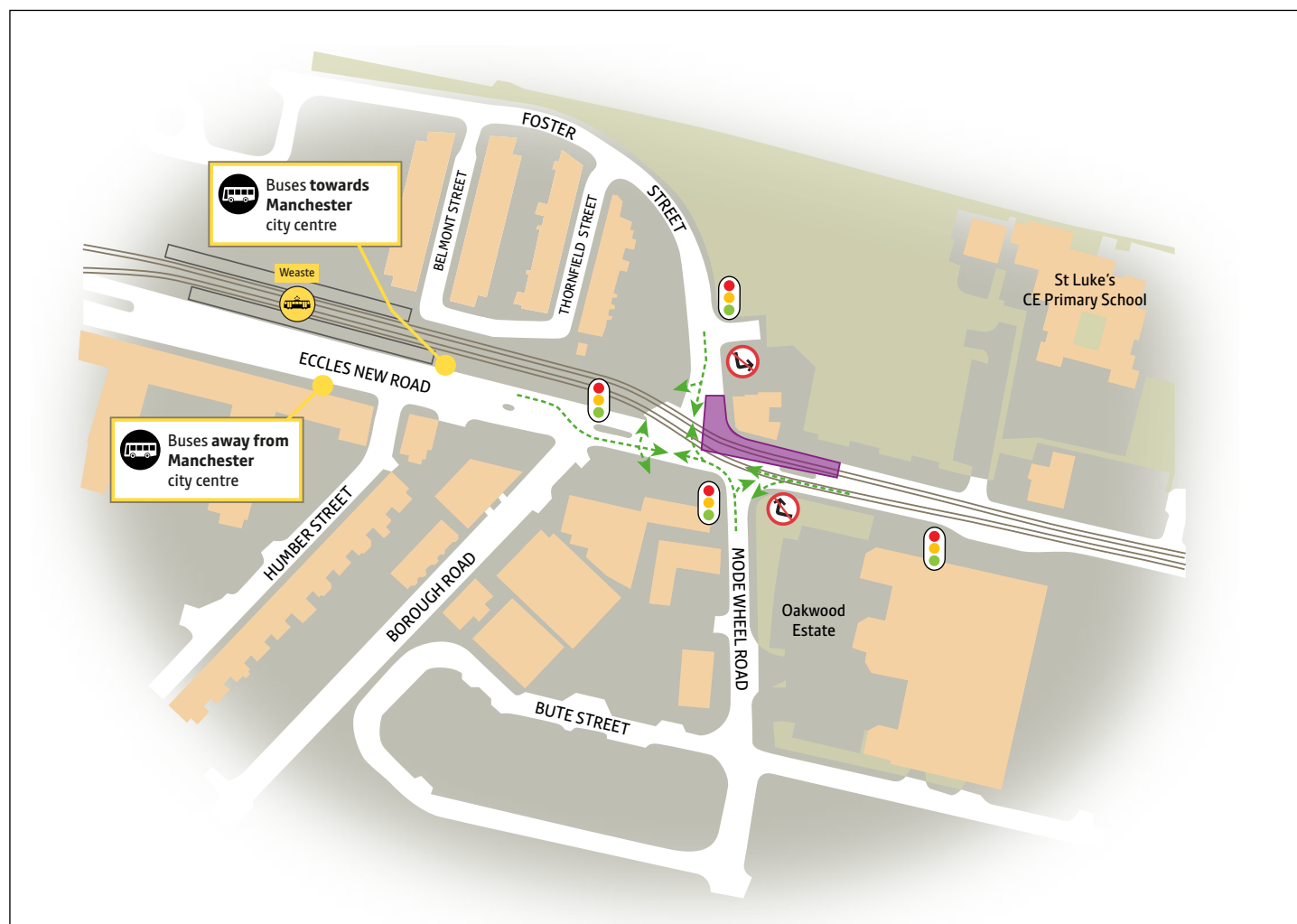

Work site	Temporary traffic lights
Replacement bus service temporary bus stop	Temporary prohibited turns
Metrolink stop	Traffic flow



© Crown copyright and database rights 2012 Ordnance Survey 0100022610. Use of this data is subject to terms and conditions. You are granted a non-exclusive, royalty free, revocable licence solely to view the Licensed Data for non-commercial purposes for the period during which Transport for Greater Manchester makes it available; you are not permitted to copy, sub-license, distribute, sell or otherwise make available the Licensed Data to third parties in any form; and third party rights to enforce the terms of this licence shall be reserved to Ordnance Survey

# Metrolink Eccles line rail maintenance works – summer 2016

## Weaste Metrolink stop

### Signed diversion route **Phase 1**

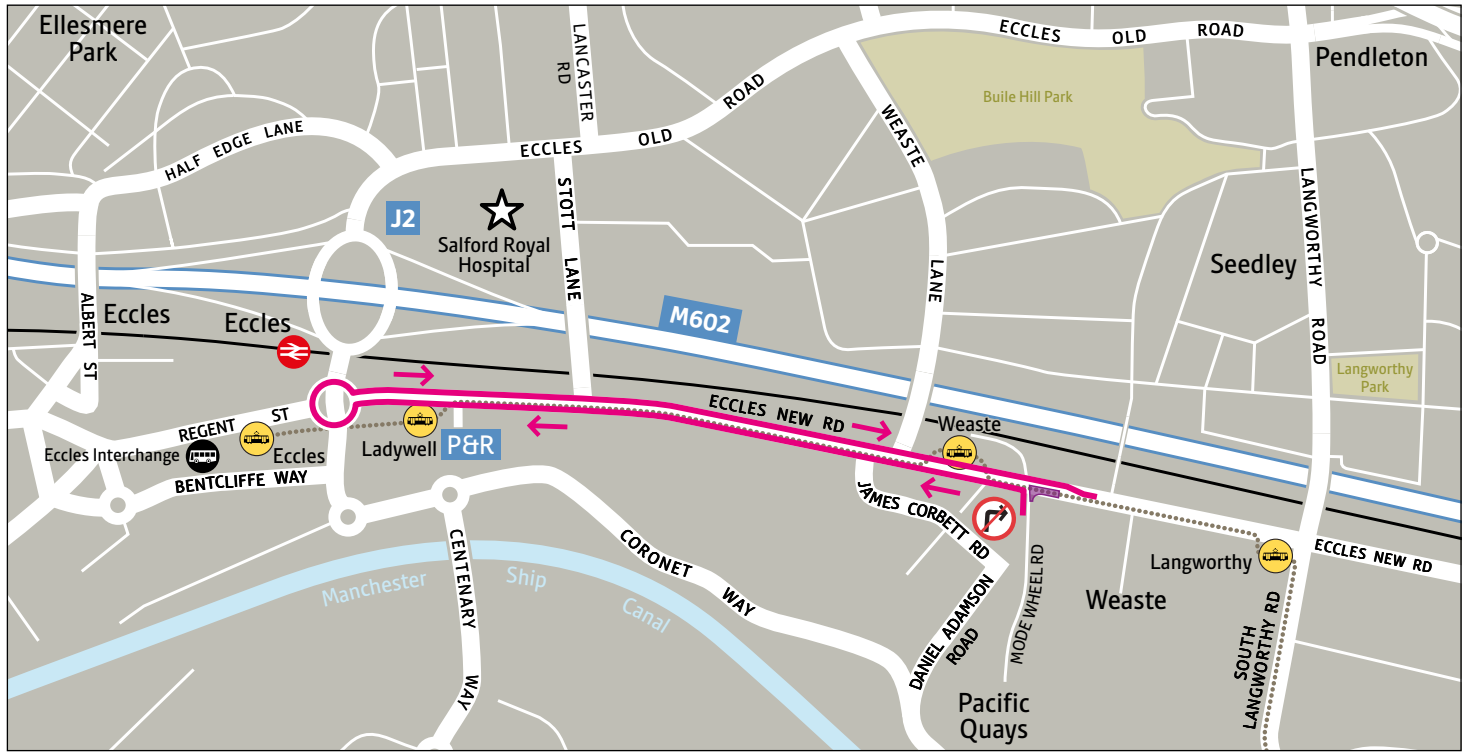

### Signed diversion route **Phase 3**

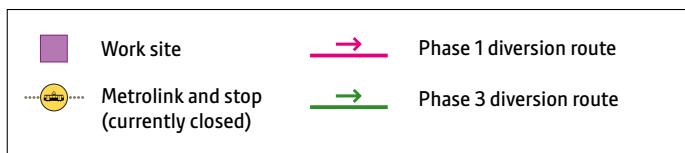
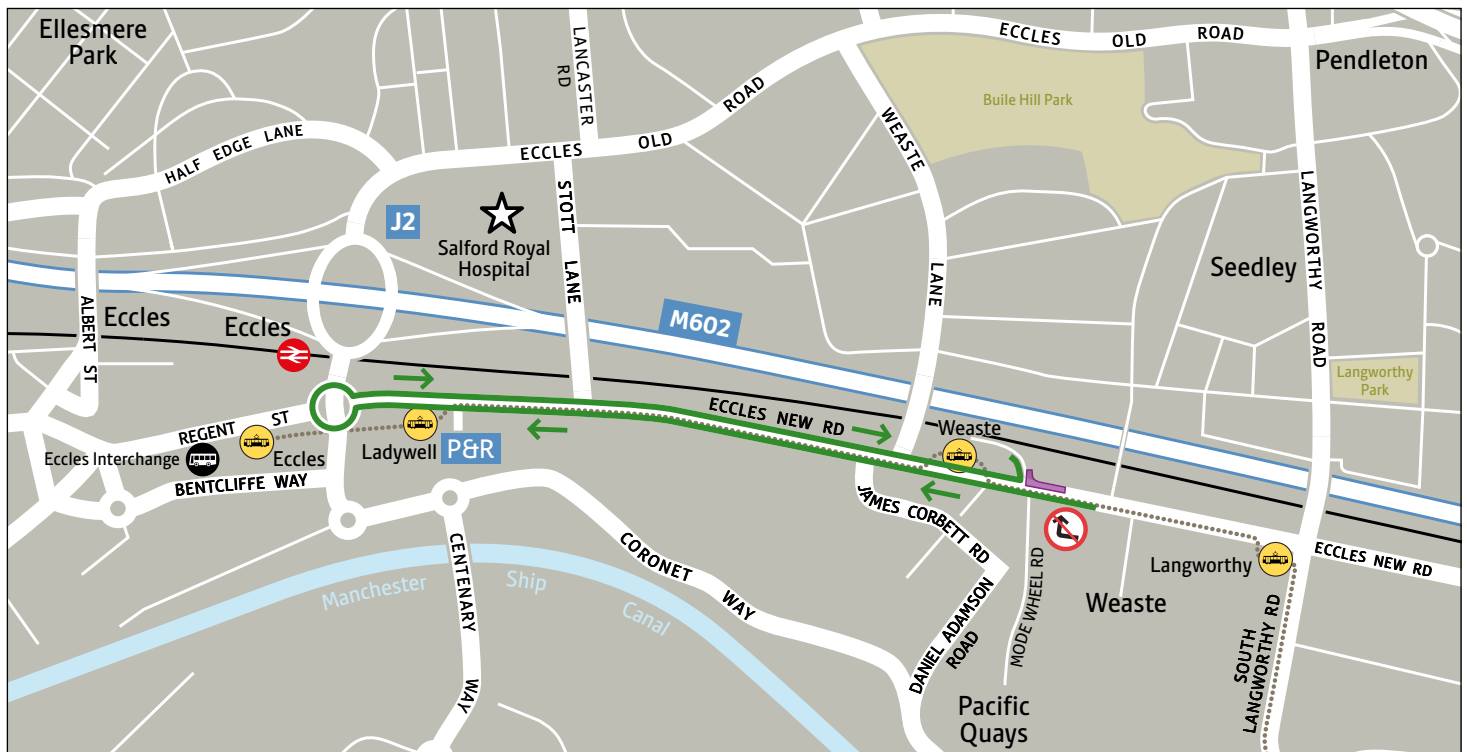

© Crown copyright and database rights 2012 Ordnance Survey 0100022610. Use of this data is subject to terms and conditions. You are granted a non-exclusive, royalty free, revocable licence solely to view the Licensed Data for non-commercial purposes for the period during which Transport for Greater Manchester makes it available; you are not permitted to copy, sub-license, distribute, sell or otherwise make available the Licensed Data to third parties in any form; and third party rights to enforce the terms of this licence shall be reserved to Ordnance Survey